



Earthmoving Machinery Spares Pty Ltd

ABN 78 394 726 341

187 Northcorp Boulevard
Broadmeadows VIC 3047

T 03 8301 9500

F 03 8301 9599

E info@emspares.com.au

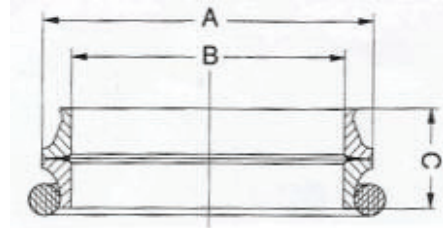
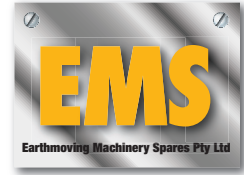

DUO CONE SEAL GROUPS FOR CATERPILLAR

Part No	OD A(mm)	ID B(mm)	Width C(mm)	Seal Type	Alternative Part Nos	GNL Ref	Berco Ref
1) Caterpillar Seal Groups							
1796862	457.2	429.2	38.0	S	1456033, 9W6623, 9W7205, 9W6622		
1796863	533.4	505.4	44.0	S	1456034, 9W6644, 9W6822, 3T6602		CR4050
1796864	700.0	667.0	44.0	S	1456035, 9W7206, 6T6803		
1696442	394.5	366.5	38.0	S	Alt. to 9W6620 & Replaces 9W6619		
3P1848	119.1	100.1	31.8	S	9W7230	CR3604	CR3934
5P0374					Use 9W6680		
5P0375	157.0	142.7	25.4	S	6Y2194	CR3845	
5P0376				S	Use 9W6675		
5P5829	259.6	231.6	38.0	S	9W6618, 6Y0520, 9W2621, 9W6617	CR3863	
5P7146	146.1	126.0	31.8	V	9W7243, 5P7147	CR3515	
6Y0855					Use 9W7204		
6Y0857					Use 9W6630		
6Y0859					Use 9W6686		
9W6620	394.5	366.5	38.0	S	9W6619, 9W3956	CR3804	CR4048
9W6623					Use 1796862		
9W6630	346.5	319.0	46.0	N	5P0991, 9G4357, 6Y0858, 6Y0857	CR3618	CR2983
9W6644					Use 1796863		
9W6645	157.0	142.7	25.4	N	5K5288, 5K5126	CR3840	CR3105
9W6646	157.0	142.7	25.4	S		CR3865	
9W6647	92.1	73.1	31.8	N	1M8747, 6Y0925	CR3307	CR1131
9W6648	92.1	73.1	31.8	S	4S8984	CR3323	CR3924
9W6649				N	7T0158, 6V1799, 7T0154	CR3900	CR4143
9W6650					7T5133	-	CR5282
9W6651				N	7T0159, 6V2733	CR3910	CR3865
9W6666	171.7	146.3	38.0	N	4K6049, 9G5311, 9W6667	CR3120	CR1919
9W6668	191.3	163.3		N	9G5313, 7M0481, 9W6669, 6T8436	CR3242	CR1857
9W6671	210.3	182.3	38.0	N	5M1176, 9G5315, 4M2621, 9W6672	CR3260	CR1868



Earthmoving Machinery Spares Pty Ltd

ABN 78 394 726 341

187 Northcorp Boulevard
Broadmeadows VIC 3047

T 03 8301 9500

F 03 8301 9599

E info@emspares.com.au

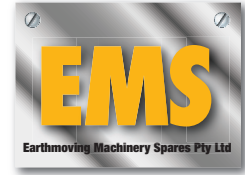

DUO CONE SEAL GROUPS FOR CATERPILLAR...CONTINUED

Part No	OD A(mm)	ID B(mm)	Width C(mm)	Seal Type	Alternative Part Nos	GNL Ref	Berco Ref
9W6674	210.3	182.4	46.0	N	9G5341, 6T8439, 9W6673, 8P1848	CR3208	CR3336
9W6675	171.7	146.3	38.0	S	5P0376, 6T2981, 6T9984, 9W6676	CR3123	CR4109
9W6680	210.3	182.4	38.0	S	5P0374, 3T6541, 6T9986, 9W6681	CR3212	CR4279
9W6684	251.5	223.5	38.0	N	5M8647, 9G5317	CR3344	CR1595
9W6686	251.5	223.5	46.0	N	6Y0860, 9G5343, 6Y0859	CR3319	CR3276
9W6688	292.9	264.9	38.0	N	9G5319, 5M1177, 9W6689, 4M0659	CR3518	CR1891
9W6691	292.9	265.0	46.0	N	9W6690, 9G5345	CR3525	CR3301
9W6692	346.5	318.5	38.0	N	5M7294, 9G5321, 9W6693, 6T8434	CR3621	CR1906
9W6694	251.5	223.5	38.0	S	5P1605, 6T2815, 9W2619	CR3326	CR3326
9W6697	292.9	264.9	38.0	S	5P1607, 3T9117	CR3530	CR4281
9W6699	346.5	318.5	38.0	S	3P1850, 3P8572, 3T8500, 9W2623	CR3625	CR4280
9W6822	533.4	505.4	44.0	N	9W2629, 6D1190.	CR3820	CR4050
9W7201	394.5	366.5	38.0	N	9G5323, 9W7203, 6T4316, 4D4510	CR3800	CR4048
9W7203					Use 9W7201		
9W7204	394.5	366.5	48.0	N	6Y0855, 6Y0856, 9G5349	CR3980	CR4596
9W7205	457.2	429.2	38.0	N	3T6604, 4D8960, 6V2458	CR3810	CR4049
9W7206	700.0	667.0	44.0	S	Use 1796864	CR3875	
9W7207	104.8	90.4	26.0	N	6S3285, 6S2772	CR3710	CR3069
9W7209	141.2	127.0	25.4	N	3S0303	CR3850	CR4046
9W7211	168.2	153.9	25.4	N	5K1078, 5K1069, 9S4296	CR3830	CR4047
9W7215	168.1	153.9	25.4	S	8L5516	CR3835	
9W7216	82.6	63.5	31.8	N	2M2858, 5K6191, 9S3521, 9W5224	CR3107	CR1291
9W7220	109.5	90.4	31.8	N	1M8746, 9S3523, 9W2142, 8E8341	CR3503	CR1195
9W7223	82.6			S	5K6191	CR3104	CR4206
9W7224	109.5	90.4	31.8	S	8S5656	CR3508	CR3918
9W7225	119.1	100.1	31.8	N	1M8748, 9S3524, 9W2201	CR3606	CR1906
9W7228	146.1	127.0	31.8	N	5P9121, 6Y5219, 9S4294	CR3700	CR4792
9W7230					Use 3P1848		
9W7232				N	7T4080	CR3975	CR4359
9W7233				N	7T0157, 6V2696	CR3920	CR3872
9W7234				N	7T0160	CR3940	CR3888
9W7235	92.1			N	6V1915	CR3970	CR4615
9W7236	92.1			N	9W1060, 6V1838	CR3965	CR4624
9W7241	119.1	100.1	31.8	V	5P7143	CR3310	-
9W7332	191.3	163.3	46.0	N	9W6670, 9W7331, 8P1857, 9G5339	CR3220	CR3358

* Also available. A complete range of SEAL GROUPS for KOMATSU